

Receiver

From

Society
Reference
Address
Phone
Fax
E-mail

Item n° :
60176857
Customer pos. no.:
Model :
FKC 65 30.2 T5 400D

Pump data

Type of impeller : Single vane impeller
Pump outlet : DN 65
Pump inlet : DN 65
Flange standard : EN 1092-1 / PN 16
Free passage : 65 mm
Fluid Temperature : 0 °C / 40 °C *
* For higher temperatures please contact our sales network
pH : 6,5 - 12
Kinematic viscosity : 1 mm²/s
Max Flow : 94 m³/h
Max. Head : 23,48 m
Max. Hydraulic efficiency : 62,9 %

Approvals

Approvals : 12050-1
ATEX : NO

INSTALLATION

Max. Ambient temperature : 40 °C
Max. installation depth : 20 m
Type of installation :
Wet - Pump only

Materials

Handle : Stainless Steel (AISI 304)
Electric cable : 07RN8-F
Screws : Stainless Steel (AISI 304)
OR : NBR
Mechanical seal pump side : SiC/SiC
Mechanical seal motor side : SiC/Carbon
Motor shaft : AISI 420
Pump body / motor : Cast iron (EN GJL 200)
Impeller : Cast iron (EN GJL 250)
Wear ring : Cast iron (EN GJL 150)
Coating : Acrylic Two-component 50µm

Motor data

Number of poles : 2
Max. Input power P1 : 3,42 kW
Nominal power P2 : 3 kW
Rated voltage : 3~ 400 V (+6% / -10%) 50 Hz
Nominal current : 5,8 A
Starting current (DOL / YD) : 19,1 A / —
Starting : Direct starting
Rated speed : 2.900 1/min
Efficiency : 87,8 %
Number of starts : 20 /h
Degree of protection : IP 68
Insulation class : F 150 °C
Standard cable type : 10mt 4G1.5+3x1
Water-in-oil sensor : NO
Motor protection : Thermal switch

Curve tolerance according to ISO 9906

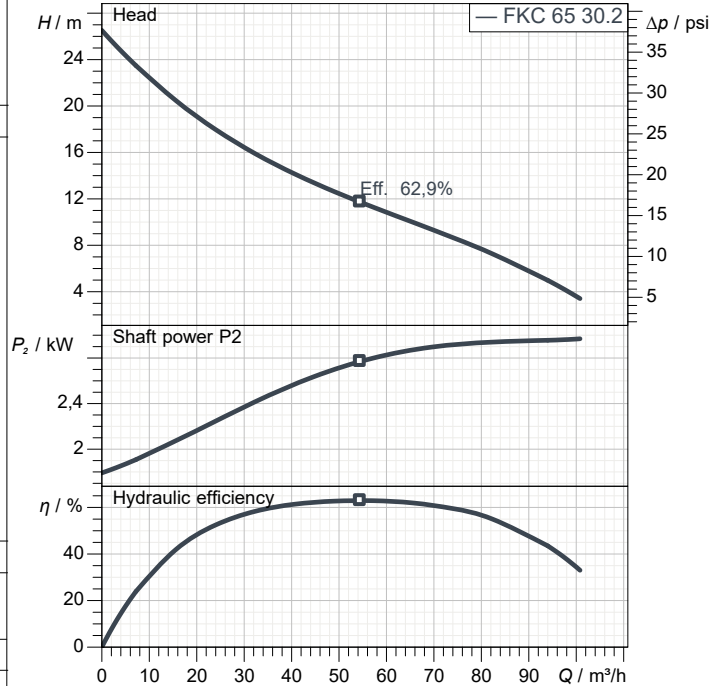

Fluid data

Fluid : Water
Density : 998,3 kg/m³
Fluid Temperature : 20 °C
Kinematic viscosity : 1,005 mm²/s

Requested data

Flow :
Head :

Real duty point

Flow :
Head :

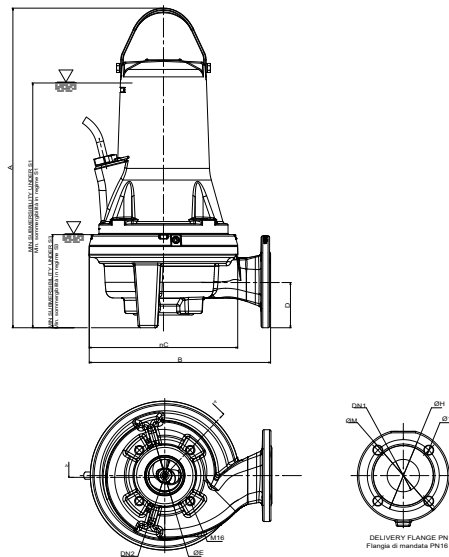

Pump weight : 93 kg

Accessory weight :

Dimensions in

mm

A	645	ØH	145
B	365	ØM	185
D	91	S1	494
DN1	65	S3	188
DN2	65		
Ø18	4xØ18		
ØC	300		
ØE	145		

Receiver

From

Society
Reference
Address
Phone
Fax
E-mail

Installation example

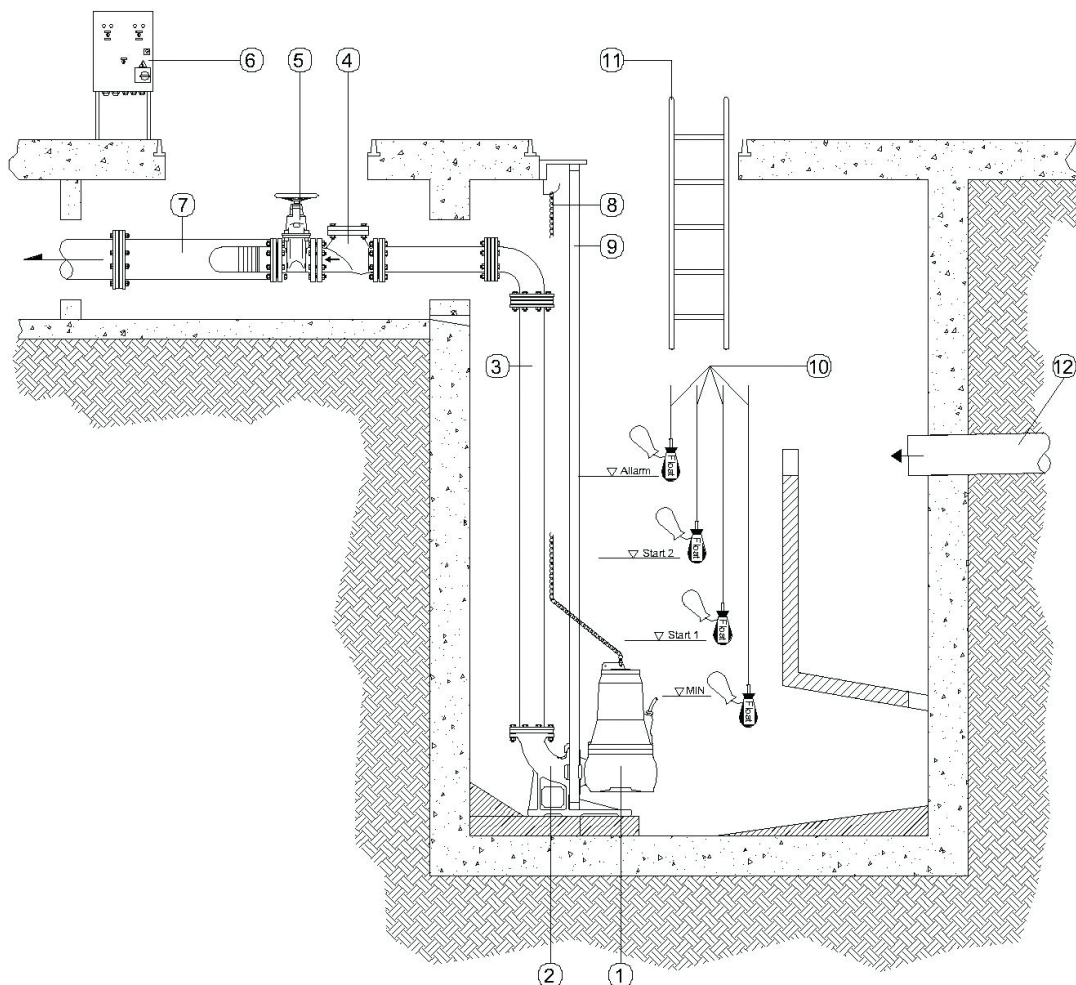

- 1: SUBMERSIBLE PUMPS
- 2: BASE ELBOW
- 3: DISCHARGE PIPE
- 4: BALL CHECK VALVE
- 5: GATE VALVE
- 6: CONTROL PANEL
- 7: MANIFOLD
- 8: LIFTING CHAIN
- 9: DROP PIPE
- 10: LEVEL SWITCHES
- 11: SUMP INSPECTION LADDER
- 12: INTAKE PIPE



PERFORMANCE CURVES

2023-02-22

Page 3 / 4

DAB PUMPS S.p.A.
Via Marco Polo, 14 - 35035 Mestrino (PD), Italy
Tel. +39 049 5125000 - Fax +39 049 5125950
www.dabpumps.com

Receiver

From

Society
Reference
Address
Phone
Fax
E-mail

FKC 65 30.2 T5 400D

Curve tolerance according to ISO 9906

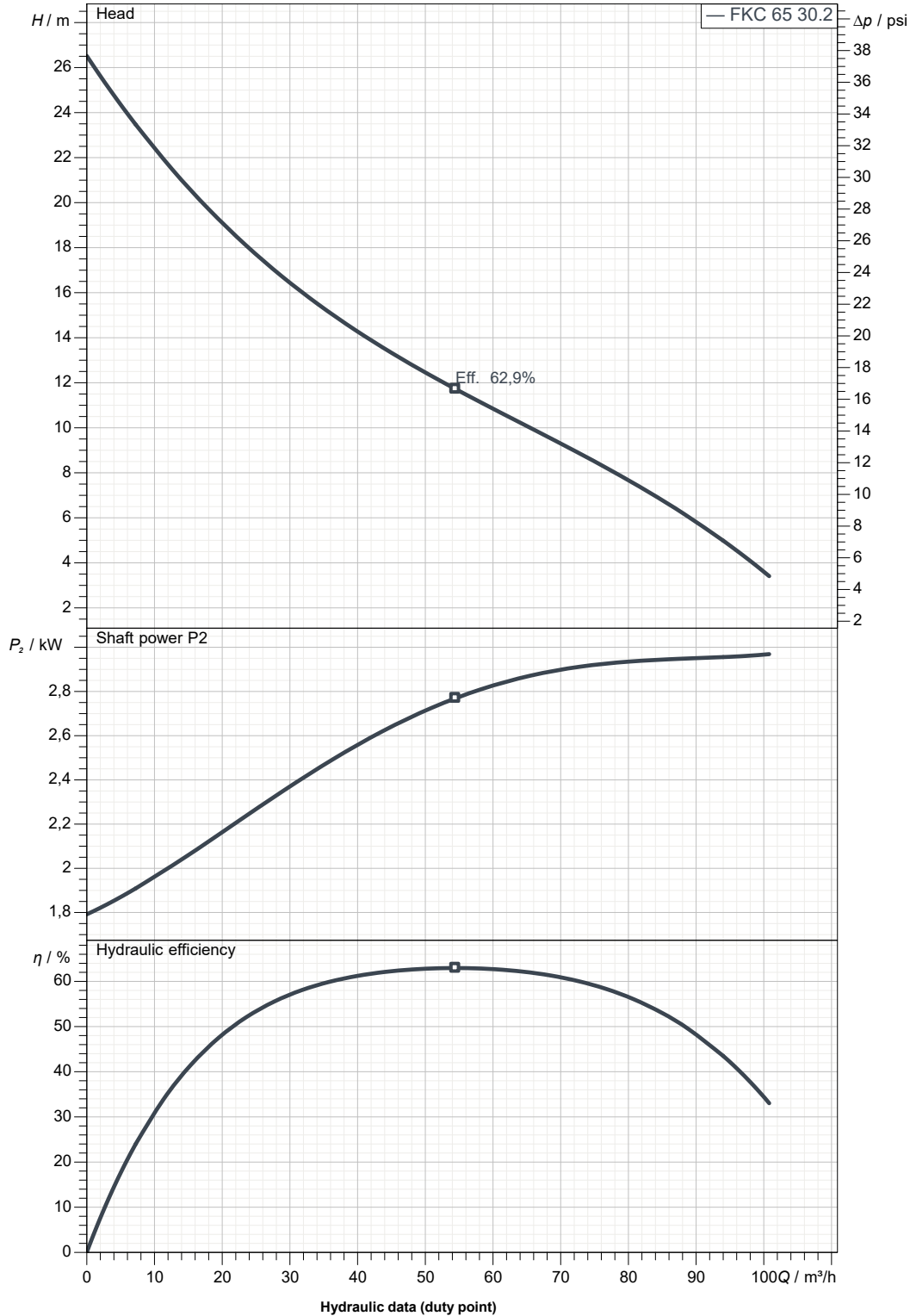

Suction side :
DN 65
PN 16

Discharge side :
DN 65
PN 16

Flow :

Head :

Rated speed :
2.900 1/min

MAIN_PROJECT_TITLE

BUSINESS_PROCESS_ID

OWNER_

ISSUE_DATE
2023-02-22



DIMENSIONAL DRAWING

2023-02-22

Page 4 / 4

DAB PUMPS S.p.A.
Via Marco Polo, 14 - 35035 Mestrino (PD), Italy
Tel. +39 049 5125000 - Fax +39 049 5125950
www.dabpumps.com

Receiver

From

Society
Reference
Address
Phone
Fax
E-mail

FKC 65 30.2 T5 400D

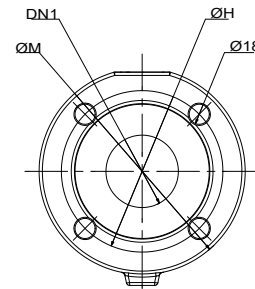
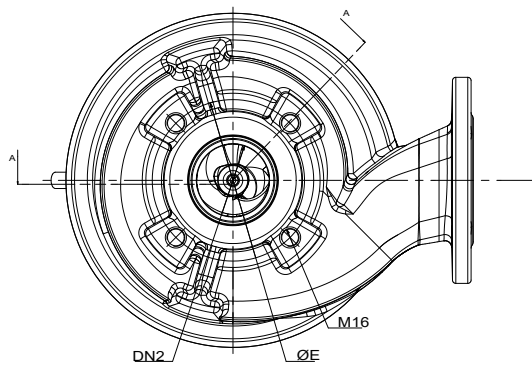
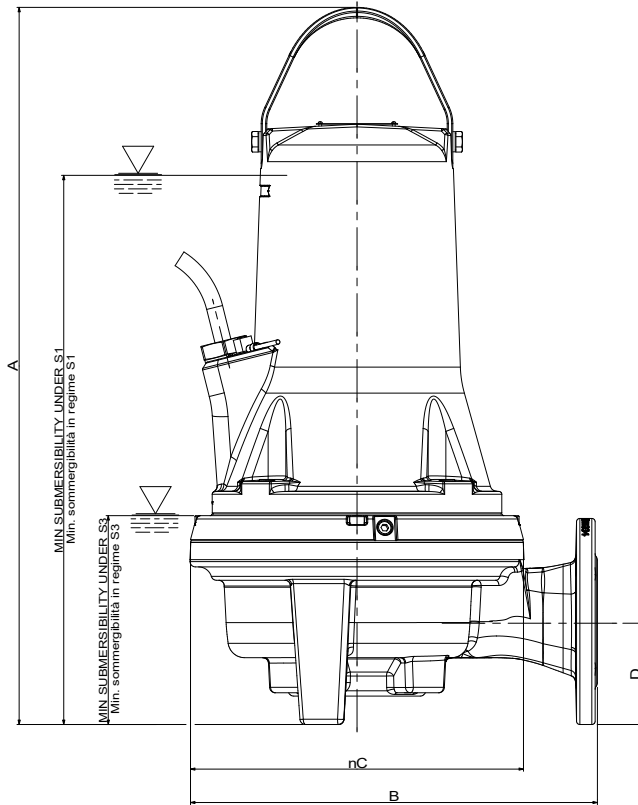

DELIVERY FLANGE PN16
Flangia di mandata PN16

Dimensions in mm					Pump connection	
1	A	645	S3	188		
2	B	365			Suction	
3	D	91			DN 65	
4	DN1	65			PN 16	
5	DN2	65			Discharge	
6	Ø18	4xØ18			DN 65	
7	ØC	300			PN 16	
8	ØE	145				
9	ØH	145				
10	ØM	185				
11	S1	494				

MAIN_PROJECT_TITLE	BUSINESS_PROCESS_ID	OWNER	ISSUE_DATE 2023-02-22
--------------------	---------------------	-------	---------------------------------